

DOUBLE PLASTIC FILTERS (DISC&SCREEN) DD,DE

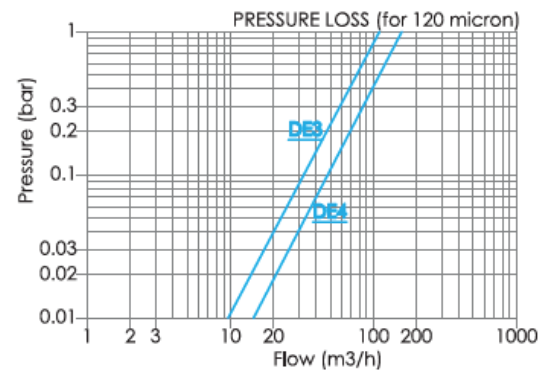
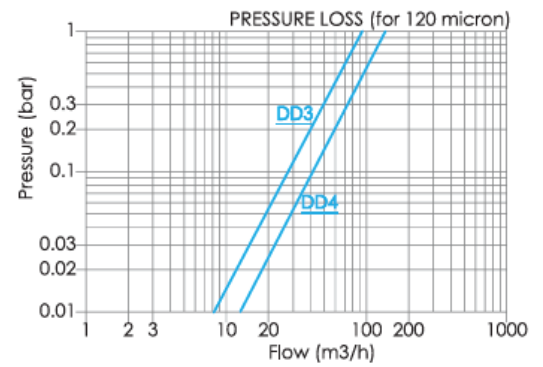
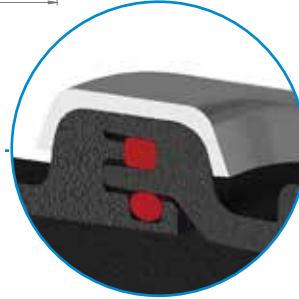
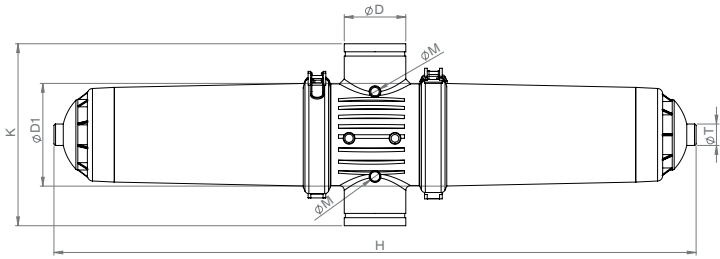

| Code | D | M | T | D1 | H | K | Flow | Filter Surface Area | Weight |
|------|------|-----|-----|-----|------|-----|-------------------|---------------------|--------|
| | inch | | | mm | | | m ³ /h | cm ² | kg |
| DD3 | 3 | 1/4 | 3/4 | 190 | 960 | 340 | 50 | 2604 | 11,4 |
| DD4 | 4 | 1/4 | 3/4 | 190 | 960 | 340 | 70 | 2604 | 11,6 |
| DDS3 | 3 | 1/4 | 3/4 | 190 | 1200 | 340 | 60 | 3610 | 13,6 |
| DDS4 | 4 | 1/4 | 3/4 | 190 | 1200 | 340 | 80 | 3610 | 13,8 |
| DE3 | 3 | 1/4 | 3/4 | 190 | 960 | 340 | 50 | 2280 | 8,4 |
| DE4 | 4 | 1/4 | 3/4 | 190 | 960 | 340 | 70 | 2280 | 8,6 |
| DES3 | 3 | 1/4 | 3/4 | 190 | 1200 | 340 | 60 | 3040 | 9,8 |
| DES4 | 4 | 1/4 | 3/4 | 190 | 1200 | 340 | 80 | 3040 | 10 |

General Characteristics

Body Material : Pa %30 Gfr

Cartridge Material: Pp (Disc) Pa (Screen Aisi 304 Cage Pa)

Maximum Workig Pressure : 8 Bar (116 Psi)

Maximum Working Temperature:60 C/ 140 F

The Filtration Degree: 20-50-100-125 Micron

Cartridge Of Filters:

D: Disc Cartridge

E:Screen Cartridge

