

12 11 10 9 8 7 6 5 4 3 2 1

H G F E D C B A

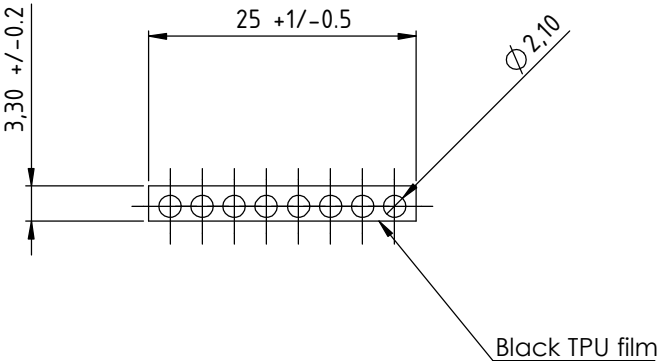
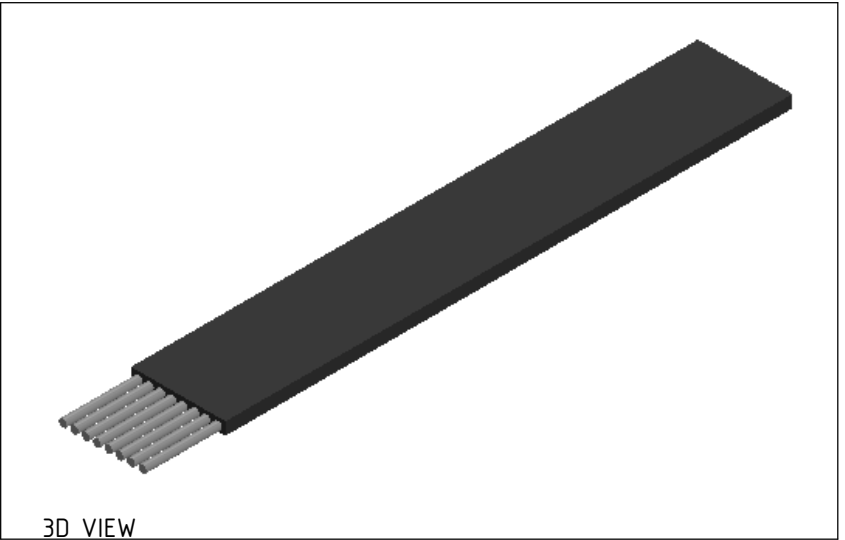

Type of body material	Black PU, 92 ShA	
Cord type	Steel, 8 cords 2.1 mm	
Belt width	25 $\pm 0.5$	[mm]
Thickness	3.3 $\pm 0.2$	[mm]
Breaking strength	41600	[N]
Min bending diameter	100	[mm]

	DESCRIPTION:	MEGALINEAR 25 P3 cord 2.1
	OEM'S TEAM ENGINEER:	
DATA:		
MATERIAL:	DRAWING N°	201803301434-GA
SCALE:1:1	CUSTOMER:	

ALL RIGHTS RESERVED:  
 This drawing/document is exclusive property of Megadyne SPA which reserves all rights thereto. This drawing/document cannot be copied, reproduced, communicated, disclosed to others or used in any way, not even for experimental purposes, without a written authorization from Megadyne SPA. If requested it shall be promptly returned to Megadyne SPA.

12 11 10 9 8 7 6 5 4 3 2 1