



PFA9165A0015005

Home Page | [Print](#)

Price: € 100,20



IP 65 CE EAC

Ratio 1:15,82

Cable clamp PRPS0062PE - CABLE CLAMP M16

Notes

Shaft

Code ALL1R00001

End side Front  
 Length (L) 35,00 mm  
 Flexible No  
 Standard diameter 8 mm  
 End type Radial hole  
 Dimension A 4,00 mm  
 Dimension B 7,00 mm

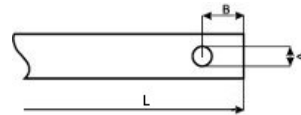

Cam Set Code: PRFC0202PEC

Cams	Switches
4	PRSL7140PI PRSL0003XX
3	PRSL7140PI PRSL0003XX
2	PRSL7140PI PRSL0003XX
1	PRSL7140PI PRSL0003XX

Note: cams numbering is bottom up

Anti condensation option

Serial numbering

No-drop wire

This configuration has been saved in our records and will be valid 180 days from the date of creation. After that date it will be deleted. The image is representative and does not match the actual product.

For more information on this product or to get a quote contact us

## TER Tecno Elettrica Ravasi srl

### Sede Operativa / Headquarter

Via Garibaldi 29/31  
23885 Calco (LC) - Italy  
Tel. +39 039 99.11.011  
Fax +39 039 99.10.445  
E-mail [info@terworld.com](mailto:info@terworld.com)

### Sede Legale / Registered Office

Via San Vigilio 2 - 23887 Olgiate Molgora (LC) - Italy  
Capitale sociale / Capital stock € 150.000  
R.E.A Lecco N. 136104 - M.I.C. 001225  
Registro Imprese di Lecco / Business register in Lecco  
C.F P.IVA / Fiscal Code/VAT no. 00222410136  
PEC [tecnoelettricaravasi@pec.edlegal.it](mailto:tecnoelettricaravasi@pec.edlegal.it)

"Do you want receive TER news updates?"

---

[Subscribe to our newsletter](#)

[Term of privacy](#)



© 2012 TER Tecno Elettrica Ravasi srl